

**341 20 Street N
Lethbridge, Alberta**

MLS # A2263634

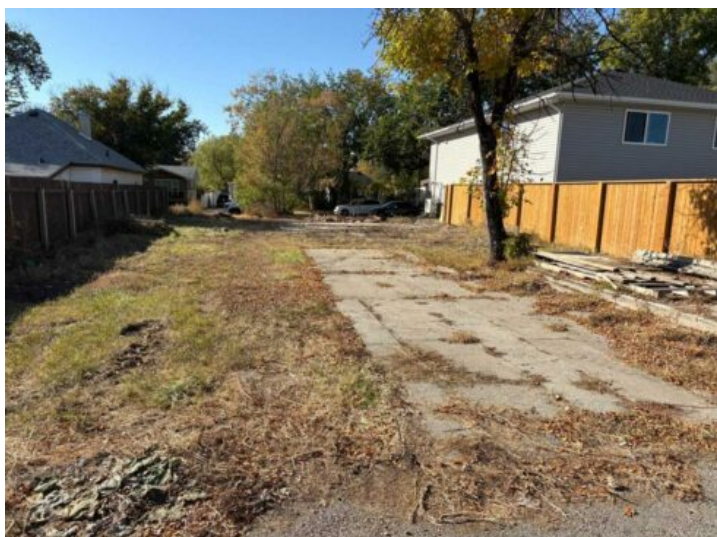

\$149,000

Division: Westminster

Lot Size: 0.14 Acre

Lot Feat: Back Lane, Interior Lot, Level

By Town: -

LLD: -

Zoning: R-L(W)

Water: -

Sewer: -

Utilities: -

Welcome to 341 20 Street North, Lethbridge — a fantastic 50 x 125 ft lot in the established community of Westminster. This spacious parcel offers plenty of room for your dream home, garage, or investment property, with convenient rear lane access for flexible parking or future development options. Enjoy living close to parks, schools, shopping, and quick access to major routes — all while being just minutes from downtown. Whether you’re a builder, investor, or homeowner looking for the perfect infill location, this property checks the boxes. Don’t miss this affordable opportunity to build new in a mature neighbourhood.