



780-832-5880

cord@gpremax.com

1909 Parkside Way
Coaldale, Alberta

MLS # A2239476

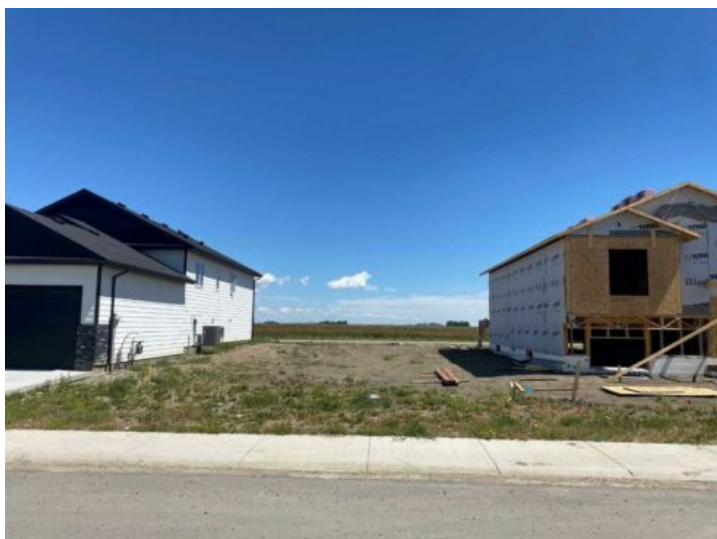

\$99,900

Division: NONE

Lot Size: 0.10 Acre

Lot Feat: -

By Town: -

LLD: -

Zoning: r-l

Water: -

Sewer: -

Utilities: -

Nice, quiet lot across from adult living. End of a crescent with little traffic. Proposed grocery store within walking distance. Lot faces East giving shelter to the backyard. Almost 4300 sq ft gives you many options to build your dream home!